

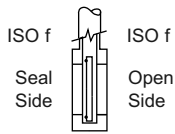

- Simple End Operated Air Cylinder
- Over 100,000 Cycles Without Maintenance
- Helium Tested to 5 X 10⁻¹⁰ scc/s
- All Valves (RoHS) 2002/95/EC Compliant
- Flanges to Match Diffusion & Cryo Pumps
- Optional Operation to 10 Bar, 147 PSIG
- Optional Remote Position Indicators
- NW & Compression Gauge & Roughing Ports
- Automatic Closure on Power Failure

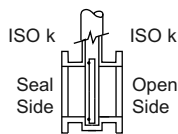

N1 Tapped Holes on Both Sides



N5 Neck on Both Sides

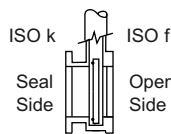

N6 Neck on Seal Side

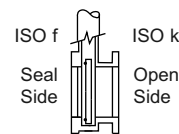

N8 Neck Opposite Seal Side

Stainless Steel Gates in Aluminum Valves: To specify a stainless steel gate in an aluminum valve add a suffix to the model number "SS Gate". Refer to the "Optional Features and Accessories" pages in the Accessories and Parts section of this catalog for pricing information.

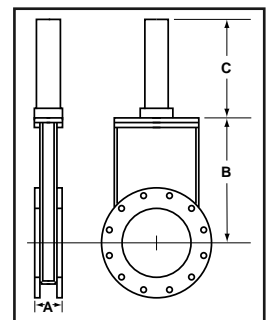

ORDERING INFORMATION

Model Number: Refer to pg. 2 for instructions on how to specify the features you need.

Position Indicators: Two reed switches activated by a magnet inside the pneumatic actuator provide closure for open and closed position. SPST contacts rated 0.5A @ 110 or 220 VAC non-inductive. Add LSE to Model Number.....\$138.00 /pair

Gauge and Roughing Ports: See page 46 for sizes and prices.

Special Features: Refer to pages 44 & 45 for information on special features and accessories.

Viton® or Kalrez® or Silicone O-Rings: Our standard Valves use a Viton® O-Ring for the gate seal and Buna-N O-Rings for all other locations. You may specify Viton® (or other materials) throughout the valve with a "V", "S", or "K" in the model number. For Viton® add the following to the price. (For Silicone or Kalrez® contact the factory for prices.)

- 63 mm valves.....\$50.
- 100 mm valves.....\$76.
- 160 mm valves.....\$94.
- 200 mm valves.....\$150.
- 250 mm valves.....\$196.
- 320 mm valves.....\$252.

| ISO Port Size | Model No. ISO Flange | Port Dia. | Flange O.D. | Bolt Circle Dimensions in mm | (number of bolts) size - pitch | A Flange to Flange | B mm | C mm | List Price |
|---------------|-------------------------------------|-----------|-----------------|------------------------------|--------------------------------|--------------------|------|------|------------|
| KF-50 | END ISO KF-50 | 50 | Not Applicable. | | STD. KF-50 | 95 | 159 | 187 | \$916. |
| 63 mm | END ISO 63, N1, both sides ISO-f | 70 | 130 | 110 | (4) M 8 - 1.25 | 80 | 159 | 187 | \$957. |
| | END ISO 63, N5, both sides ISO-k | 70 | 95 | 110 | no bolts, ISO-k | 105 | 159 | 187 | \$1158. |
| | END ISO 63, N6 & N8, ISO-f & ISO-k | 70 | 130/95 | 110 | (4) M 8 - 1.25 | 90 | 159 | 187 | \$1050. |
| 100 mm | END ISO 100, N1, both sides ISO-f | 102 | 165 | 145 | (8) M 8 - 1.25 | 105 | 213 | 239 | \$1528. |
| | END ISO 100, N5, both sides ISO-k | 102 | 130 | 145 | no bolts, ISO-k | 127 | 213 | 239 | \$1688. |
| | END ISO 100, N6 & N8, ISO-f & ISO-k | 102 | 165/130 | 145 | (8) M 8 - 1.25 | 111 | 213 | 239 | \$1626 |
| 160 mm | END ISO 160, N1, both sides ISO-f | 153 | 225 | 200 | (8) M 10 - 1.5 | 105 | 289 | 296 | \$1657. |
| | END ISO 160, N5, both sides ISO-k | 153 | 180 | 200 | no bolts, ISO-k | 143 | 289 | 296 | \$1862. |
| | END ISO 160, N6 & N8, ISO-f & ISO-k | 153 | 225/180 | 200 | (8) M 10 - 1.50 | 127 | 289 | 296 | \$1785. |
| 200 mm | END ISO 200, N1, both sides ISO-f | 213 | 285 | 260 | (12) M 10 - 1.5 | 111 | 364 | 348 | \$2521. |
| | END ISO 200, N5, both sides ISO-k | 213 | 240 | 260 | no bolts, ISO-k | 155 | 364 | 348 | \$2907. |
| | END ISO 200, N6 & N8, ISO-f & ISO-k | 213 | 285/240 | 260 | (12) M 10 - 1.5 | 127 | 364 | 348 | \$2778. |
| 250 mm | END ISO 250, N1, both sides ISO-f | 261 | 335 | 310 | (12) M 10 - 1.5 | 117 | 484 | 406 | \$3427. |
| | END ISO 250, N5, both sides ISO-k | 261 | 290 | 310 | no bolts, ISO-k | 219 | 484 | 406 | \$3715. |
| | END ISO 250, N6 & N8, ISO-f & ISO-k | 261 | 335/290 | 310 | (12) M 10 - 1.5 | 168 | 484 | 406 | \$3550. |
| 320 mm | END ISO 320, N1, both sides ISO-f | 318 | 425 | 395 | (12) M 12 - 1.75 | 117 | 533 | 457 | \$4723. |
| | END ISO 320, N5, both sides ISO-k | 318 | 370 | 395 | no bolts, ISO-k | 219 | 533 | 457 | \$4862. |
| | END ISO 320, N6 & N8, ISO-f & ISO-k | 318 | 425/370 | 395 | (12) M 12 - 1.75 | 168 | 533 | 457 | \$4790. |
| 400mm | END ISO 400, N1, ISO-f both sides | 400 | 510 | 480 | (16) M 12 - 1.75 | 165 | 702 | 560 | \$8613. |
| 500mm | END ISO 500, N1, ISO-f both sides | 500 | 610 | 580 | (16) M 12 - 1.75 | 203 | 908 | 730 | \$13516. |
| 630mm | END ISO 630, N1, ISO-f both sides f | 630* | 780 | 720 | (20) M 12 - 1.75 | 216 | 978 | 851 | \$19453. |

* 630 mm Port diameter flange will have a step of 651 mm diameter for center ring.



Model Numbering System

VRC Valves are
Manufactured in
the USA.



Vacuum Research valves are available with dozens of options to allow you to select exactly the features you need for your vacuum system. The model number system illustrated below will accurately describe most valves, but if you have any questions about the best way to specify what you need, just call or fax our customer service department and we will be happy to help you. All Valves (RoHS) 2002/95/EC Compliant.

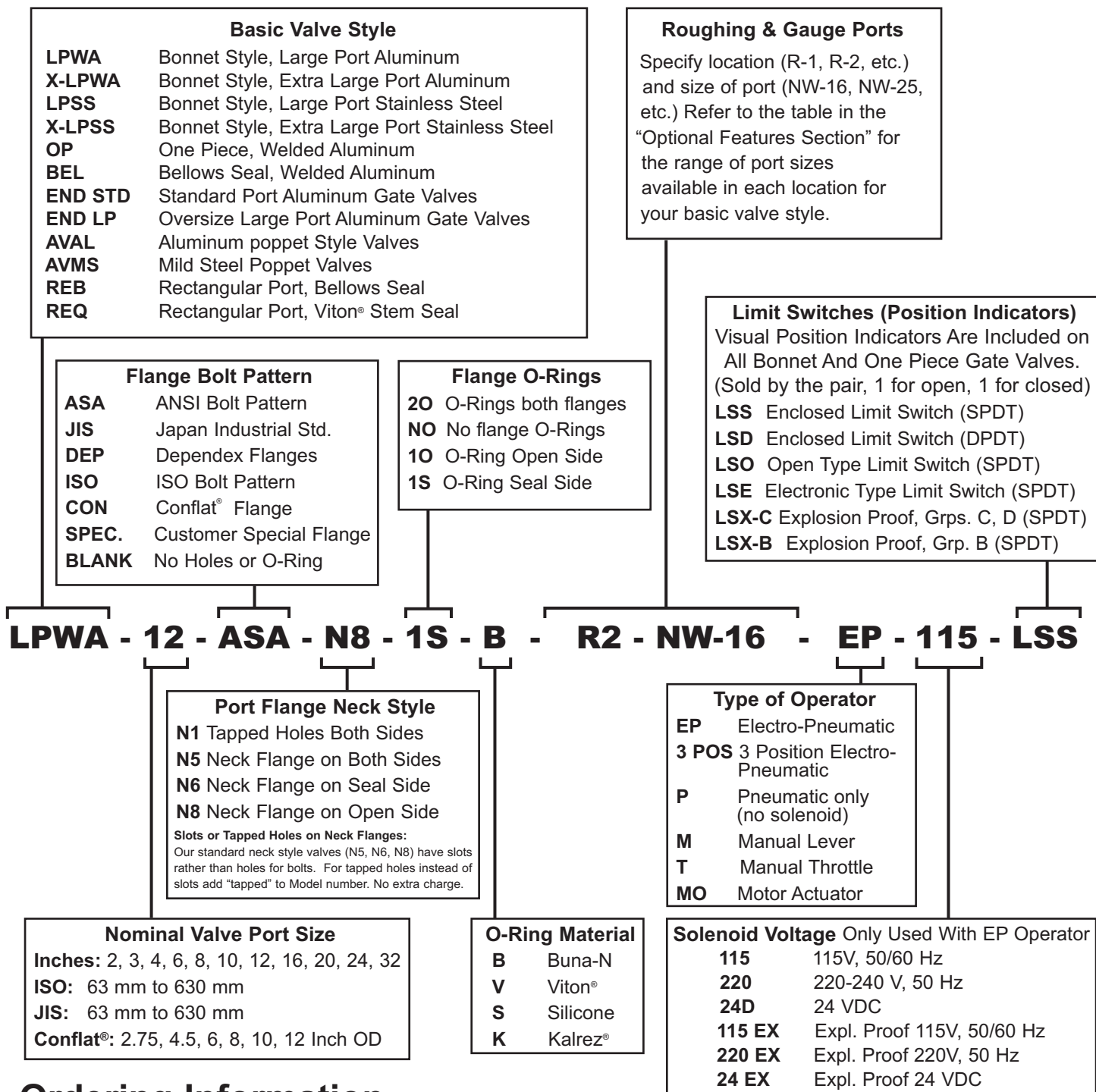

Ordering Information



Call our toll free number (800) 426-9340, or (412) 261-7630 to place orders, or for customer service. Our FAX number is (412) 261-7220. Address orders by mail to Vacuum Research Corporation,



2419 Smallman Street, Pittsburgh, PA 15222 USA. Prices in this catalog are FOB factory. CIF or C&F prices available. Contact factory for pro forma invoice or price quotation. Terms are Net 30 Days.



Kalrez® and Viton® are registered trademarks of Dupont Corp. • Conflat® is a registered trademark of Varian Associates • Throttlemaster™ is a registered trademark of Vacuum Research Corporation