

End Operated Aluminum Gate Valves; Standard Size Ports with ANSI Flanges

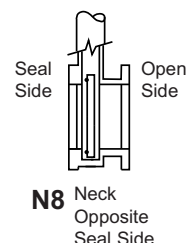

Stainless Steel Gates in Aluminum Valves: To specify a stainless steel gate in an aluminum valve add a suffix to the model number "SS Gate". Refer to the "Optional Features and Accessories" page of this catalog for pricing information.

- Less Outgassing Than Stainless, See Page 43
- Simple End Operated Air Cylinder
- Helium Tested to 5×10^{-10} scc per second
- All Valves (RoHS) 2002/95/EC Compliant
- Flanges to Match Diffusion & Cryo Pumps
- Optional Operation to 10 Bar, 147 PSIG
- Optional Remote Position Indicators
- NW & Compression Gauge & Roughing Ports
- Automatic Closure on Power Failure

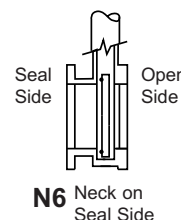
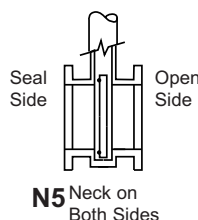
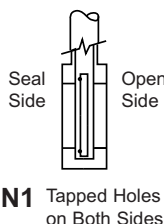

Nominal Size	Model No. Dimensions in Inches	Port Dia.	Flange O.D.	Flange O-Rings	Bolt Circle	(no. of bolts) x bolt size	Flange to Flange A	B	C	List Price
2 inch	END STD 2 N1	2.00	6.00	3.50 ID x .139	4.75	(4) 5/8-11	3.125	6.25	7.375	\$1054.
2 inch	END STD 2 N5	2.00	6.00	3.50 ID x .139	4.75	(4) Slotted	4.875	6.25	7.375	\$1251.
2 inch	END STD 2 N6 & 8	2.00	6.00	3.50 ID x .139	4.75	Neck Side Slotted	4.00	6.25	7.375	\$1152.
3 inch	END STD 3 N1	3.00	7.50	4.00 ID x .139	6.00	(4) 5/8-11	3.75	8.375	9.406	\$1576.
3 inch	END STD 3 N5	3.00	7.50	4.00 ID x .139	6.00	(4) Slotted	6.50	8.375	9.406	\$1675.
3 inch	END STD 3 N6 & 8	3.00	7.50	4.00 ID x .139	6.00	Neck Side Slotted	5.125	8.375	9.406	\$1637.
4 inch	END STD 4 N1	4.00	9.00	5.75 ID x .139	7.50	(8) 5/8-11	4.125	8.375	9.406	\$1617.
4 inch	END STD 4 N5	4.00	9.00	5.75 ID x .139	7.50	(8) Slotted	7.125	8.375	9.406	\$1852.
4 inch	END STD 4 N6 & 8	4.00	9.00	5.75 ID x .139	7.50	Neck Side Slotted	5.625	8.375	9.406	\$1760.
6 inch	END STD 6 N1	6.00	11.00	7.50 ID x .139	9.50	(8) 3/4-10	4.375	11.375	11.656	\$1724.
6 inch	END STD 6 N5	6.00	11.00	7.50 ID x .139	9.50	(8) Slotted	7.875	11.375	11.656	\$2007.
6 inch	END STD 6 N6 & 8	6.00	11.00	7.50 ID x .139	9.50	Neck Side Slotted	6.125	11.375	11.656	\$1842.
8 inch	END STD 8 N1	8.00	13.50	9.00 ID x .275	11.75	(8) 3/4-10	4.375	14.313	13.719	\$2727.
8 inch	END STD 8 N5	8.00	13.50	9.00 ID x .275	11.75	(8) Slotted	7.875	14.313	13.719	\$2974.
8 inch	END STD 8 N6 & 8	8.00	13.50	9.00 ID x .275	11.75	Neck Side Slotted	6.125	14.313	13.719	\$2850.
10 inch	END STD 10 N1	10.00	16.00	12.00 ID x .275	14.25	(12) 7/8-9	4.625	19.063	15.969	\$3782.
10 inch	END STD 10 N5	10.00	16.00	12.00 ID x .275	14.25	(12) Slotted	8.125	19.063	15.969	\$4090.
10 inch	END STD 10 N6 & 8	10.00	16.00	12.00 ID x .275	14.25	Neck Side Slotted	6.375	19.063	15.969	\$3939.
12 inch	END STD 12 N1	12.00	19.00	13.00 ID x .275	17.00	(12) 7/8-9	4.625	21.00	18.00	\$4723.
12 inch	END STD 12 N5	12.00	19.00	13.00 ID x .275	17.00	(12) Slotted	8.125	21.00	18.00	\$5022.
12 inch	END STD 12 N6 & 8	12.00	19.00	13.00 ID x .275	17.00	Neck Side Slotted	6.375	21.00	18.00	\$4872.
14 inch	END STD 14 N1	14.00	21.00	15.00 ID x .275	18.75	(12) 1-8	6.50	27.625	22.03	\$8263.
16 inch	END STD 16 N1	16.00	23.50	17.50 ID x .275	21.25	(16) 1-8	6.50	27.625	22.03	\$8618.
20 inch	END STD 20 N1	20.00	27.50	22.00 ID x .275	25.00	(20) 1 1/8-7	7.88	35.75	27.031	\$13,516.
22 inch	END APD CRYO SHI-APD CP-22	21.75	27.50	No O-Ring on Pump Side	25.00	(20) 1 1/8-7	7.625	37.75	27.031	\$13,516.
24 inch	END STD 24 N1	24.00	32.00	26.00 ID x .275	29.50	(20) 1 1/4-7	8.56	42.50	30.50	\$19,448.

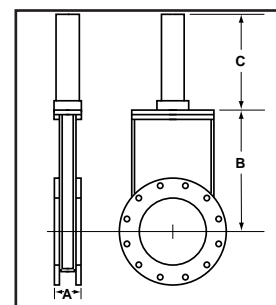

ORDERING INFORMATION

Model Number: Refer to pg. 2 for instructions on how to specify the features you need.

Position Indicators: Two reed switches activated by a magnet inside the pneumatic actuator provide closure for open and closed position. SPST contacts rated 0.5A @ 110 or 220 VAC non-inductive. Add LSE to Model No.....\$138.00 /pair

Gauge and Roughing Ports: See page 46 for sizes and prices.

Special Features: Refer to page 44 and 45 for information on special features and accessories.

Viton® or Kalrez® or Silicone O-Rings: Our standard Valves use a Viton® O-Ring for the gate seal and Buna-N O-Rings for all other locations. You may specify Viton® (or other materials) throughout the valve with a "V", "S", or "K" in the model number. For Viton® add the following to the price. (For Silicone or Kalrez® contact the factory for prices.)

2 or 3 in. valves.....	\$50.
4 in. valves.....	\$76.
6 in. valves.....	\$94.
8 in. valves.....	\$150.
10 in. valves.....	\$196.
12 in. valves.....	\$252.



End Operated Aluminum Gate Valves; Over Size Large Ports with ANSI Flanges



- Less Outgassing Than Stainless, See Page 43
- Simple End Operated Air Cylinder
- Over 100,000 Cycles Without Maintenance
- Helium Tested to 5×10^{-10} scc/s
- All Valves (RoHS) 2002/95/EC Compliant
- Flanges to Match Diffusion & Cryo Pumps
- Optional Operation to 10 Bar, 147 PSIG
- Optional Remote Position Indicators
- NW & Compression Gauge & Roughing Ports
- Automatic Closure on Power Failure

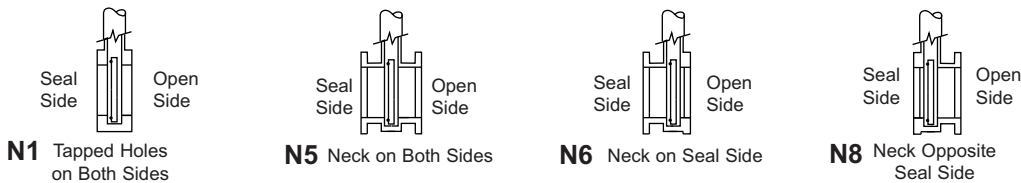

Stainless Steel Gates in Aluminum Valves: To specify a stainless steel gate in an aluminum valve add a suffix to the model number "SS Gate". Refer to the "Optional Features and Accessories" page in the Accessories and Parts section of this catalog for pricing information.

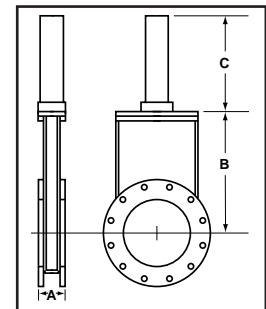

ORDERING INFORMATION

Model Number: Refer to pg. 2 for instructions on how to specify the features you need.

Position Indicators: Two reed switches activated by a magnet inside the pneumatic actuator provide closure for open and closed position. SPST contacts rated 0.5A @ 110 or 220 VAC non-inductive.

Add LSE to Model No.....\$138.00 /pair

Gauge and Roughing Ports: See page 46 for sizes and prices.

Special Features: Refer to pages 44 and 45 for information on special features and accessories.

Viton® or Kalrez® or Silicone O-Rings: Our standard Valves use a Viton® O-Ring for the gate seal and Buna-N O-Rings for all other locations. You may specify Viton® (or other materials) throughout the valve with a "V", "S", or "K" in the model number. For Viton® add the following to the price. (For Silicone or Kalrez® contact the factory for prices.)

2 or 3 in. valves.....	\$50.
4 in. valves	\$76.
6 in. valves	\$94.
8 in. valves.....	\$150.
10 in. valves.....	\$196.
12 in. valves.....	\$252.

Nominal Size	Model No. Dimension in Inches	Port Diam.	Flange O.D.	Flange O-Rings Dimensions in Inches	Bolt Circle	(no. of bolts) x bolt size	A Flange to Flange	B	C	List Price
2 inch	END LP2 N1	2.50	6.00	3.50 ID x .139	4.75	(4) 5/8-11	3.125	8.375	9.406	\$1055.
2 inch	END LP2 N5	2.50	6.00	3.50 ID x .139	4.75	(4) Slotted	4.875	8.375	9.406	\$1250.
2 inch	END LP2 N6 & 8	2.50	6.00	3.50 ID x .139	4.75	Neck Side Slotted	4.00	8.375	9.406	\$1152.
3 inch	END LP3	4.00	7.50	4.5 ID x .139	6.00	(4) 5/8-11	3.75	8.375	9.406	\$1576.
3 inch	END LP3	4.00	7.50	4.5 ID x .139	6.00	(4) Slotted	6.50	8.375	9.406	\$1675.
3 inch	END LP3 N6 & 8	4.00	7.50	4.5 ID x .139	6.00	Neck Side Slotted	5.125	8.375	9.406	\$1637.
4 inch	END LP4 N1	6.00	9.00	6.25 ID x .139	7.50	(8) 5/8-11	4.125	11.375	11.656	\$1617.
4 inch	END LP4 N5	6.00	9.00	6.25 ID x .139	7.50	(8) Slotted	7.125	11.375	11.656	\$1852.
4 inch	END LP4 N6 & 8	6.00	9.00	6.25 ID x .139	7.50	Neck Side Slotted	5.625	11.375	11.656	\$1760.
6 inch	END LP6 N1	8.00	11.00	8.25 ID x .139	9.50	(8) 3/4-10	4.375	14.313	13.719	\$1847.
6 inch	END LP6 N5	8.00	11.00	8.25 ID x .139	9.50	(8) Slotted	7.875	14.313	13.719	\$2130.
6 inch	END LP6 N6 & 8	8.00	11.00	8.25 ID x .139	9.50	Neck Side Slotted	6.125	14.313	13.719	\$1965.
8 inch	END LP8 N1	10.00	13.50	10.50 ID x .139	11.75	(8) 3/4-10	4.375	19.063	15.969	\$3066.
8 inch	END LP8 N5	10.00	13.50	10.50 ID x .139	11.75	(8) Slotted	7.875	19.063	15.969	\$3313.
8 inch	END LP8 N6 & 8	10.00	13.50	10.50 ID x .139	11.75	Neck Side Slotted	6.125	19.063	15.969	\$3190.
10 in.	END LP10 N1	12.00	16.00	12.50 ID x .275	14.25	(12) 7/8-9	4.625	21.00	18.00	\$3782.
10 in.	END LP10 N5	12.00	16.00	12.50 ID x .275	14.25	(12) Slotted	8.125	21.00	18.00	\$4090.
10 in.	END LP10 N6 & 8	12.00	16.00	12.50 ID x .275	14.25	Neck Side Slotted	6.375	21.00	18.00	\$3936.
22 in.	END APD CRYO SHI-APD CP-22	21.75	27.50	No O-Ring on Pump (Seal) side	25.00	(20) 1 1/8-7	7.625	37.75	27.031	\$13,516.



Model Numbering System

VRC Valves are
Manufactured in
the USA.



Vacuum Research valves are available with dozens of options to allow you to select exactly the features you need for your vacuum system. The model number system illustrated below will accurately describe most valves, but if you have any questions about the best way to specify what you need, just call or fax our customer service department and we will be happy to help you. All Valves (RoHS) 2002/95/EC Compliant.

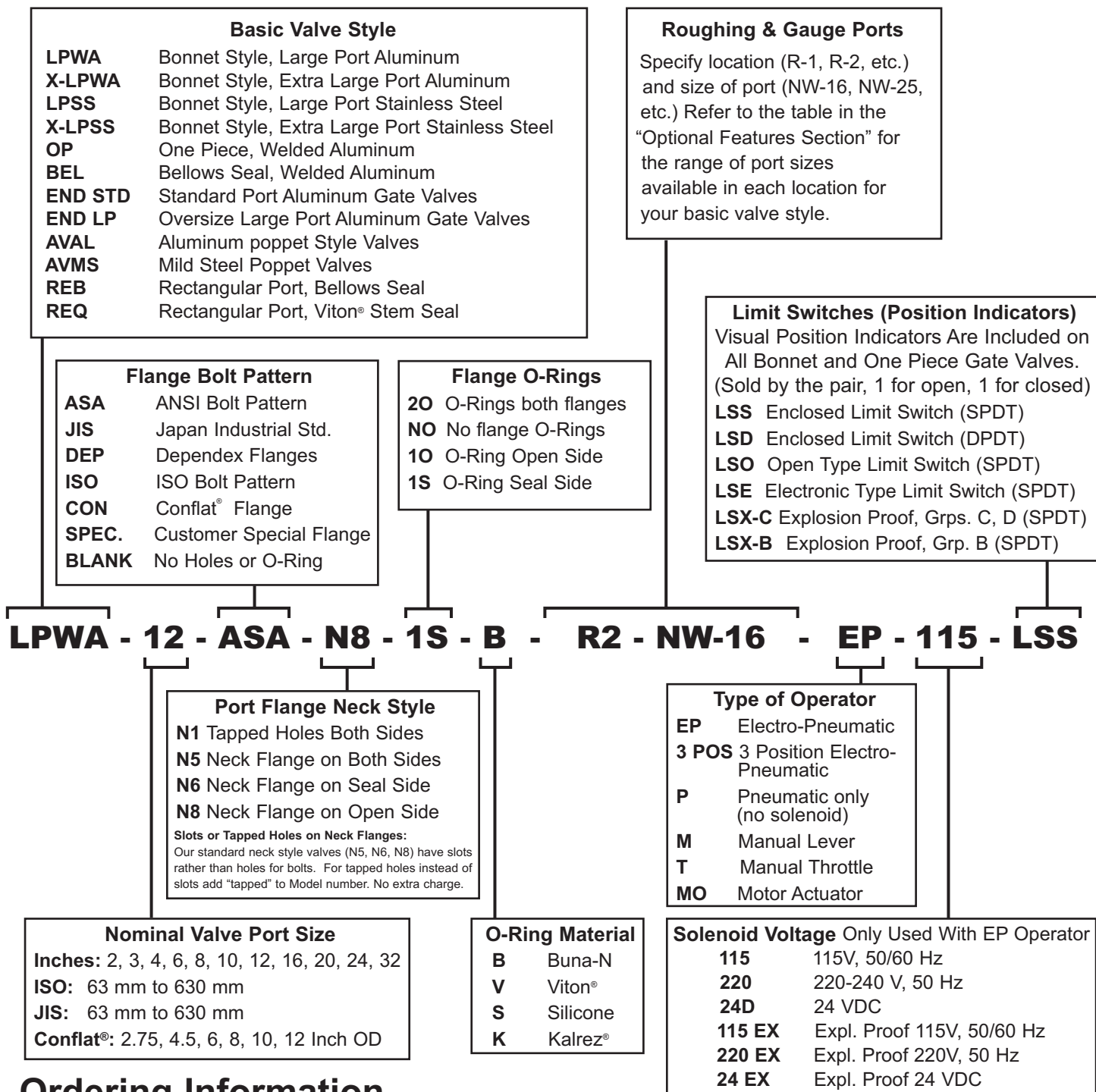

Ordering Information



Call our toll free number (800) 426-9340, or (412) 261-7630 to place orders, or for customer service. Our FAX number is (412) 261-7220. Address orders by mail to Vacuum Research Corporation, 2419 Smallman Street, Pittsburgh, PA 15222 USA. Prices in this catalog are FOB factory. CIF or C&F prices available. Contact factory for pro forma invoice or price quotation. Terms are Net 30 Days.



Kalrez® and Viton® are registered trademarks of Dupont Corp. • Conflat® is a registered trademark of Varian Associates • Throttlemaster™ is a registered trademark of Vacuum Research Corporation